

HYPERION DIAMETER TOLERANCE

Hyperion Exceeds Industry Standards with Advanced Rotary Tool Blank Specification Technology

Hyperion Diameter Tolerance Specifications

Diameters (in)		HYPERION Tolerances (in)	
From	To		
3/32	1/8	-0.00010	-0.00026
1/8	3/4	-0.00010	-0.00030
3/4	1-1/8	-0.00010	-0.00035
1-1/8	2	-0.00010	-0.00040



Tolerances

FINISHED GROUND										
Diameters (mm)		Diameters (in)		Current Industry Standard Tolerance (in)	ISO h6 Tolerances (converted to in)		ISO h5 Tolerances Ranges (converted to in)		Hyperion Tolerances Ranges (in)	
From	To	From	To							
2	3	3/32	1/8	-0.0001 to 0.0004	-0.00024	+0.0	-0.00016	+0.0	-0.00010	-0.00026
3	6	1/8	1/4		-0.00031	+0.0	-0.00020	+0.0	-0.00010	-0.00030
6	10	1/4	3/8		-0.00035	+0.0	-0.00024	+0.0	-0.00010	-0.00030
10	18	3/8	3/4		-0.00043	+0.0	-0.00031	+0.0	-0.00010	-0.00030
18	30	3/4	1-1/8		-0.00051	+0.0	-0.00035	+0.0	-0.00010	-0.00035
30	50	1-1/8	2		-0.00063	+0.0	-0.00043	+0.0	-0.00010	-0.00040

Tolerance Ranges

FINISHED GROUND										
Diameters (mm)		Diameters (in)		Current Industry Standard Range (in)	ISO h6 Tolerance Ranges (converted to in)		ISO h5 Tolerance Ranges (converted to in)		Hyperion Tolerance Ranges (in)	
From	To	From	To							
2	3	3/32	1/8	0.00050	0.00024		0.00016		0.00016	
3	6	1/8	1/4		0.00031		0.00020		0.00020	
6	10	1/4	3/8		0.00035		0.00024		0.00020	
10	18	3/8	3/4		0.00043		0.00031		0.00020	
18	30	3/4	1-1/8		0.00051		0.00035		0.00025	
30	50	1-1/8	2		0.00063		0.00043		0.00030	

RU GI Hyperion Code Example

1/2 in (D) x 3 in (L) rod: RU GI 0500 03005 6U

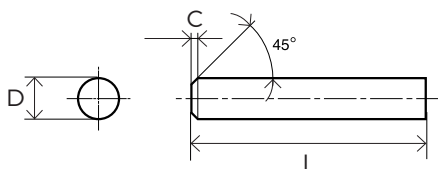

Tolerances	Tolerance Ranges (in)	Minimum ← Ø RANGE → Maximum
h6	0.00043	
h5	0.00031	
HYPERION	0.00020	